



2026 COLLECTION

A family business caring about customer satisfaction





A family business caring about customer satisfaction

Here at Europa Caravans, we build family holidays. Turn the pages of this brochure, and picture yourself and your family in one of our extensive range of beautifully crafted holiday homes.

We lovingly pour over 50 years of knowledge and experience into each one of our designs. So, when you invest in a Europa Caravan, you get a real home-from-home – a stylish base in the sun and a cosy retreat on rainy days. Our exteriors are striking and the interiors comfortable and modern. Our fabrics and furniture have a contemporary feel and the kitchen and fittings are carefully designed and practical.

Our collection offers something to suit every taste and budget – there's a holiday home here for you. Browse these pages and imagine. This is where memories begin.



PROLOCKED
Security Windows

ESTABLISHED IN 2009
MANUFACTURED IN



Europa Caravans Limited reserves the right to vary the specifications of its caravans without notice, and at such times and in such manner as it deems necessary. Table settings, ornaments, toys, electrical appliances, duvet covers and pillowcases (other than those shown as standard fixtures and fittings on each caravan) are displayed for photographic purposes only and do not form part of the contract of sale.

All dimensions quoted are approximate, and Europa Caravans Limited reserves the right to change sizes and materials, fittings etc., shown in this brochure without notice. If you have any doubts as to what is or is not included in your purchase, or the specification and layout of the caravan you are considering purchasing, it is your responsibility to establish those facts before you sign a contract of purchase.

The information displayed in this leaflet is correct at the time of printing. In the event of supply shortages, alternative materials may have to be used or alterations may have to be made to the models. Details of any such changes may be obtained from your dealer. All colours have been matched as close as printing techniques permit. Variations may occur when compared with the actual fabrics.





The Collection



4 Redwood



20 Willow Classic



36 Cypress 12



8 Sequoia



24 Willow



40 Cypress 10



12 Mulberry Neo



28 Juniper



44 Rosewood Outlook



16 Mulberry



32 Maple



48 Rosewood



52 Warranty



53 Features

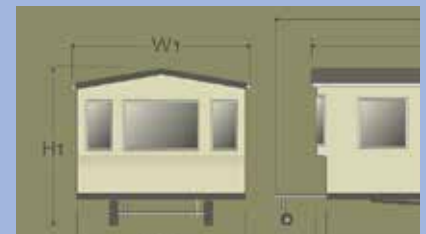

54 Dimensions



55 Security Windows



The Redwood is the new flagship van in our range. It's innovative design from top to bottom includes many ground breaking creative and functional features.

The open plan lounge, kitchen and dining area give a great feel of space whilst the sympathetic colour scheme enable it to still retain it's comfortable warm feel. The Redwood includes colour co-ordinated cupboard doors modern industrial style lighting. The master bedroom features a stunning extra large LED illuminated mirror, a walk-in wardrobe and impressive en-suite bathroom featuring a bath and shower.

All of the Redwood's stylish features combine to guarantee a chic look which oozes quality and comfort and earns it the right to be the new top of the range van.



“ The Redwood is the new flagship van in our range. It's innovative design from top to bottom includes many ground breaking features. ”







40 x 13 2 Bed



43 x 13 2 Bed



36 x 13 2 Bed

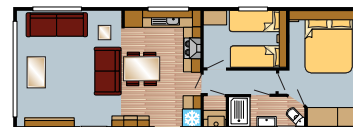

38 x 13 2 Bed



43 x 14 2 Bed

Standard Features

- Chassis fully galvanized 10 year warranty
- Pan tiled roof
- CanExcel cladded exterior
- Domestic style gutters
- Outlook doors
- Exterior light
- Downlights under the front canopy
- Anthracite uPVC double glazed
- Central heating
- 50mm fibreglass wall insulation
- 50mm fibreglass roof Insulation
- Electric fire
- Vaulted ceilings throughout
- Dividing door to hallway
- Free standing dining table & chairs
- Metal action fold out bed to lounge seating
- Scatter cushions in fabric to match curtains
- Cooker hood vented to outside
- Integrated microwave
- Integrated fridge freezer (full size)
- Integrated oven & grill with separate hob
- Integrated 450mm wide dishwasher
- Shower with thermostatic mixer
- Dual flush WC
- Extractor fan
- Deluxe mattress upgrade
- Bath (43ft vans only)
- Divan bed with storage
- Padded headboards
- USB socket in lounge and bedrooms
- Smoke alarm & Carbon monoxide detectors

Options

- uPVC cladded exterior
- Environmental green exterior
- Window colour option (see back of brochure)
- Gazunder bunk beds

Please see our matrix at the back of the brochure for a comprehensive list of options



Standard



Outlook door option

Picture yourself in the evening, relaxing in the Sequoia's stylish lounge and dining area with its plush soft furnishings and an electric fire set in a contemporary wooden surround. Rustle up a meal in the spacious kitchen with its integrated oven, separate hob and microwave. Then get a great night's sleep in the king size bed in the master bedroom. With our trademark attention to detail, we have also fitted bedside lights, a drawer unit, plenty of wardrobe space with MDF doors throughout and a TV point.

The Sequoia is finished off with vertical blinds in the lounge and dining area, soft, luxurious carpets in the lounge and bedrooms and central heating throughout as standard – it's warm, comfortable and stylish.



“ With its combination of the latest in design and affordable quality, the Sequoia deserves its reputation as a luxury holiday home. ”



Outlook door option



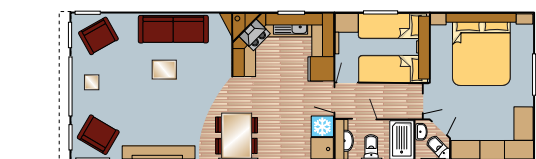

40 x 13 2 Bed

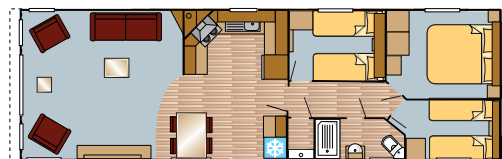

41 x 13 3 Bed

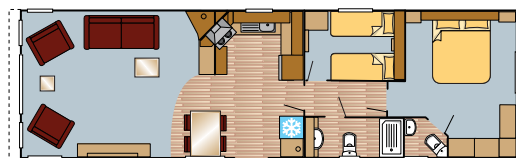

42 x 13 2 Bed

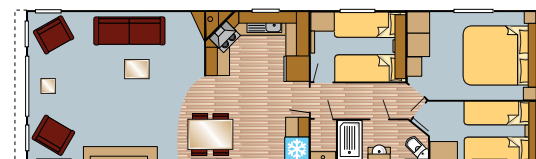

43 x 13 3 Bed



Bath Option



Separate Lounge Option



Standard Features

- Chassis fully galvanized 10 year warranty
- Pan tiled roof
- uPVC cladded exterior
- Domestic style gutters
- Exterior light
- Downlights under the front canopy
- Anthracite uPVC double glazed
- Central heating
- 50mm fibreglass wall insulation
- 50mm fibreglass roof Insulation
- Electric fire
- Vaulted ceilings throughout
- Dividing door to hallway
- Free standing dining table & chairs
- Metal action fold out bed to lounge seating
- Scatter cushions in fabric to match curtains
- Cooker hood vented to outside
- Integrated microwave
- Integrated fridge freezer (full size)
- Integrated oven & grill with separate hob
- Integrated 450mm wide dishwasher
- Shower with thermostatic mixer
- Dual flush WC
- Extractor fan
- Deluxe mattress upgrade
- Lift up storage bed to main bedroom
- Padded headboards
- USB socket in lounge and bedrooms
- Smoke alarm & Carbon monoxide detectors

Options

- Exterior door canopy
- Environmental green exterior
- Outlook doors
- Window colour option (see back of brochure)
- Bath with thermostatic mixer shower over
- Gazunder bunk beds

Please see our matrix at the back of the brochure for a comprehensive list of options



Standard



Outlook door option

Holiday in five-star luxury! The Mulberry Neo's fabulous kitchen boasts a raised work surface, an integrated fridge-freezer, oven, grill and microwave and a stainless steel cooker hood. Enjoy the view through panoramic windows as you relax in the comfort of the stylish living room with its modern furniture and attractive soft furnishings. The contemporary fire surround with electric fire makes an impressive central feature.

The quality finish continues in the bedrooms with superb soft furnishings and well-designed fitted furniture. Two bed models include a walk-in wardrobe and en suite. With so many luxury features as standard, this is a really stunning holiday home.



“ The Mulberry Neo is a luxury modern holiday home which combines a spacious living area with an array of high specification features. ”





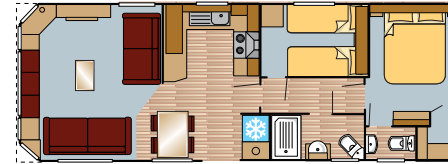

32 x 12 2 Bed

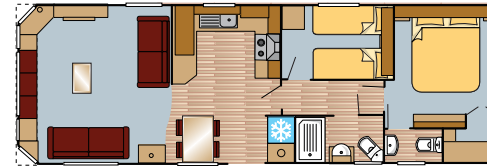

36 x 12 2 Bed

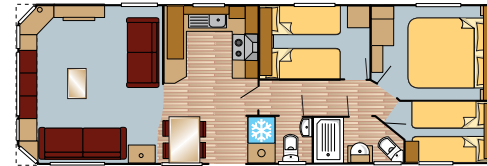

36 x 12 3 Bed



38 x 12 2 Bed

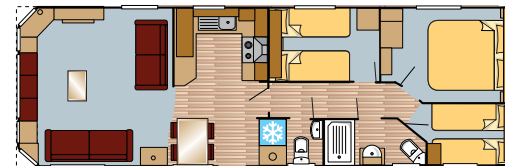

38 x 12 3 Bed

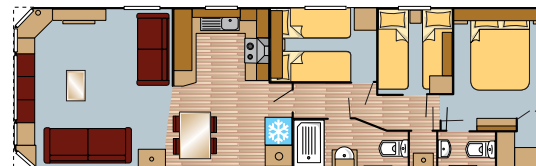

40 x 12 3 Bed

Standard Features

- Painted chassis
- Pan tiled roof
- uPVC cladded exterior
- Domestic style gutters
- Exterior light
- Antique uPVC double glazed
- Central heating
- 50mm fibreglass wall insulation
- 50mm fibreglass roof Insulation
- Electric fire
- Vaulted ceilings throughout
- Dividing door to hallway
- Free standing dining table & chairs
- Metal action fold out bed to lounge seating
- Scatter cushions in curtain fabric
- Cooker hood vented to outside
- Integrated microwave
- Integrated fridge freezer (full size)
- Integrated cooker with LED clock/minute minder
- Shower with thermostatic mixer
- Dual flush WC
- Extractor fan
- Lift up storage bed to main bedroom
- Padded headboards
- USB socket in lounge and bedrooms
- Smoke alarm & Carbon monoxide detectors

Options

- Pre galvanised chassis
- Chassis fully galvanized 10 year warranty
- Environmental green exterior
- Outlook doors
- Window colour option (see back of brochure)
- Deluxe mattress upgrade
- Net curtains throughout
- Integrated 450mm wide dishwasher
- Gazunder bunk beds
- Downlights under the front canopy

Please see our matrix at the back of the brochure for a comprehensive list of options



Standard



Outlook door option

You will really feel at home in the Mulberry! The lounge offers glorious panoramic views through the large picture windows. Modern furniture and attractive soft furnishings combine style with comfort and the electric fire makes an impressive central feature. Preparing a meal is a real pleasure in the beautiful kitchen with its raised work surfaces, contrasting cupboard doors and integrated fridge-freezer, oven, grill and microwave. Quality continues in the bedrooms with superb soft furnishings and contemporary fitted furniture. Two bed models include a walk-in wardrobe and en suite. All this, and a striking external appearance, makes the Mulberry one of our most popular models.



“ The Mulberry is a stylish, modern holiday home which combines a spacious living area with an array of high specification features. ”





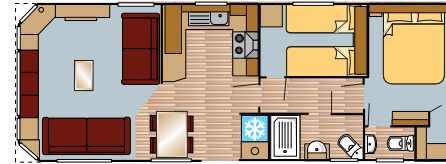

32 x 12 2 Bed

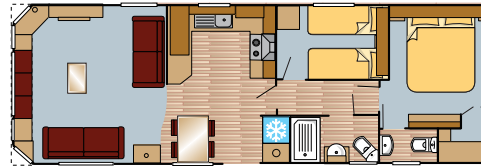

36 x 12 2 Bed

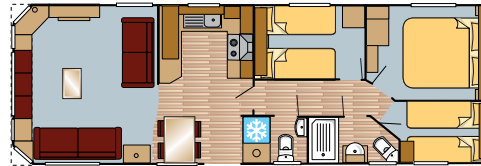

36 x 12 3 Bed

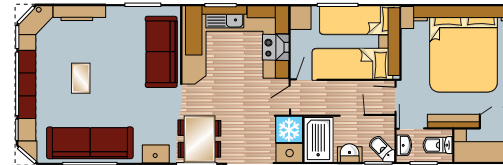

38 x 12 2 Bed

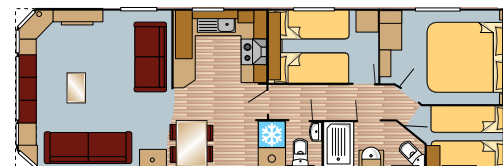

38 x 12 3 Bed

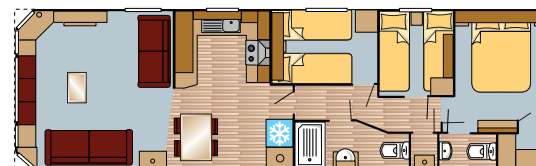

40 x 12 3 Bed

Standard Features

- Painted chassis
- Pan tiled roof
- uPVC cladded exterior
- Domestic style gutters
- Exterior light
- Anthracite uPVC double glazed
- Central heating
- 50mm fibreglass wall insulation
- 50mm fibreglass roof insulation
- Electric fire
- Vaulted ceilings throughout
- Dividing door to hallway
- Free standing dining table & chairs
- Metal action fold out bed to lounge seating
- Scatter cushions in curtain fabric
- Cooker hood vented to outside
- Integrated microwave
- Integrated fridge freezer (full size)
- Integrated cooker with LED clock / minute minder
- Shower with thermostatic mixer
- Dual flush WC
- Extractor fan
- Lift up storage bed to main bedroom
- Padded headboards
- USB socket in lounge and bedrooms
- Smoke alarm & carbon monoxide detectors

Options

- Pre galvanised chassis
- Chassis fully galvanized 10 year warranty
- Environmental green exterior
- Outlook doors
- Window colour option (see back of brochure)
- Deluxe mattress upgrade
- Net curtains throughout
- Integrated 450mm wide dishwasher
- Gazunder bunk beds
- Downlights under the front canopy

Please see our matrix at the back of the brochure for a comprehensive list of options

Willow Classic

Scan the QR code to take our online virtual tour



Standard



Outlook door option

The Willow Classic is an attractive country-style caravan with many high-end features. It's ivory coloured cupboard doors give a clean bright look and are ideal for practical living. With a freestanding dining table and upholstered chairs, the Willow Classic gives plenty of space for preparing family meals or entertaining friends.

The sofa-style seating in the lounge and warm glow from the electric fire provide superb level of comfort. Well-designed bedrooms and a spacious shower room with bowl-style sink on a vanity unit complete the specification. A choice of different layouts guarantees you'll be able find the perfect holiday home for you.



All Willow Classic photography is of the 36 x 12 2 bed unless otherwise stated. Other models may vary in layout and features. The model pictured in this brochure shows the standard window option.

“ The Willow Classic is an attractive country-style caravan with a many high-end features ”





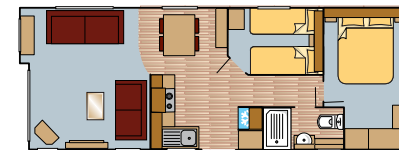

32 x 12 2 Bed



36 x 12 2 Bed

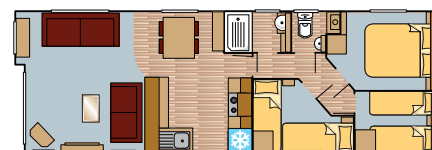

36 x 12 3 Bed



38 x 12 2 Bed

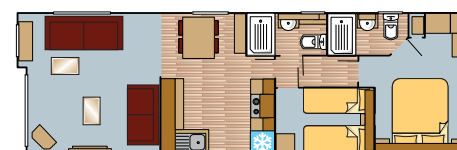

38 x 12 2 Bed 2 Shower



38 x 12 3 Bed

Standard Features

- Painted chassis
- Pan tiled roof
- uPVC cladded exterior
- Domestic style gutters
- Exterior light
- Antique uPVC double glazed
- Central heating
- 50mm fibreglass wall insulation
- 50mm fibreglass roof Insulation
- Electric fire
- Vaulted ceilings throughout
- Dividing door to hallway (Excluding 32x12 2 bed)
- Net curtains throughout
- Free standing dining table & chairs
- Metal action fold out bed to lounge seating
- Scatter cushions in fabric to match curtains
- Cooker hood vented to outside
- Integrated microwave
- Integrated fridge freezer (full size, excluding 32x12 2 bed)
- Integrated cooker with LED clock / minute minder
- Shower with thermostatic mixer
- Dual flush WC
- Extractor fan
- Lift up storage bed to main bedroom
- Padded headboards
- USB socket in lounge and bedrooms
- Smoke alarm & carbon monoxide detectors

Options

- Pre galvanised chassis
- Chassis fully galvanized 10 year warranty
- Environmental green exterior
- Outlook doors
- Window colour option (see back of brochure)
- Integrated 450mm wide dishwasher
- Deluxe mattress upgrade
- Gazunder bunk beds
- Downlights under the front canopy

Please see our matrix at the back of the brochure for a comprehensive list of options



Standard



Outlook door option

The Willow is a real home-from-home! Imagine an evening curled up on the cosy, sofa-style seating in the lounge, glass in hand, television on and electric fire giving out a warm glow! The attractive country-style kitchen is designed for practical living, whether you're preparing family meals or cooking for friends. With a freestanding dining table and upholstered chairs, the Willow is ideal for entertaining.

Well-designed bedrooms and a spacious shower room with bowl-style sink on a vanity unit complete the specification. A choice of different layouts guarantees you'll be able to find the perfect holiday home for you.



“ The Willow is a superb holiday home with many stylish features and obvious appeal. ”





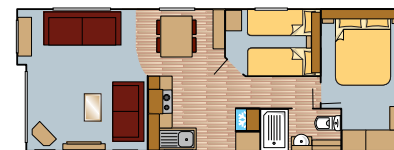

32 x 12 2 Bed



36 x 12 2 Bed

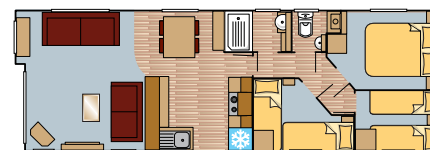

36 x 12 3 Bed

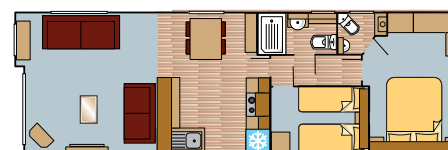

38 x 12 2 Bed



38 x 12 2 Bed 2 Shower

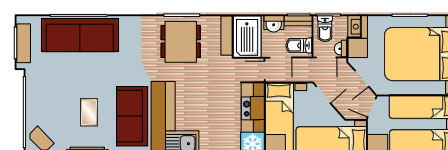

38 x 12 3 Bed

Standard Features

- Painted chassis
- Pan tiled roof
- uPVC cladded exterior
- Domestic style gutters
- Exterior light
- Antique uPVC double glazed
- Central heating
- 50mm fibreglass wall insulation
- 50mm fibreglass roof Insulation
- Electric fire
- Vaulted ceilings throughout
- Dividing door to hallway (Excluding 32x12 2 bed)
- Net curtains throughout
- Free standing dining table & chairs
- Metal action fold out bed to lounge seating
- Scatter cushions in fabric to match curtains
- Cooker hood vented to outside
- Integrated microwave
- Integrated fridge freezer (full size, excluding 32x12 2 bed)
- Integrated cooker with LED clock / minute minder
- Shower with thermostatic mixer
- Dual flush WC
- Extractor fan
- Lift up storage bed to main bedroom
- Padded headboards
- USB socket in lounge and bedrooms
- Smoke alarm & carbon monoxide detectors

Options

- Pre galvanised chassis
- Chassis fully galvanized 10 year warranty
- Environmental green exterior
- Outlook doors
- Window colour option (see back of brochure)
- Integrated 450mm wide dishwasher
- Deluxe mattress upgrade
- Gazunder bunk beds
- Downlights under the front canopy

Please see our matrix at the back of the brochure for a comprehensive list of options



With the living area centrally-positioned, the Juniper has been specially designed for holidaymakers who like spending time together during the day, but enjoy a little more privacy at bedtime. The lounge has attractive soft furnishings, and an electric fire with a contemporary fire surround makes an impressive focal point. The well-equipped, u-shaped kitchen with free-standing dining table opposite and a sliding patio door as standard, make this a pleasant place to prepare and enjoy your meals together. Bedrooms are spaced at opposite ends of the holiday home and all models include a walk-in wardrobe and en suite.



“ For those who like being together during the day, but prefer more privacy when night falls. ”

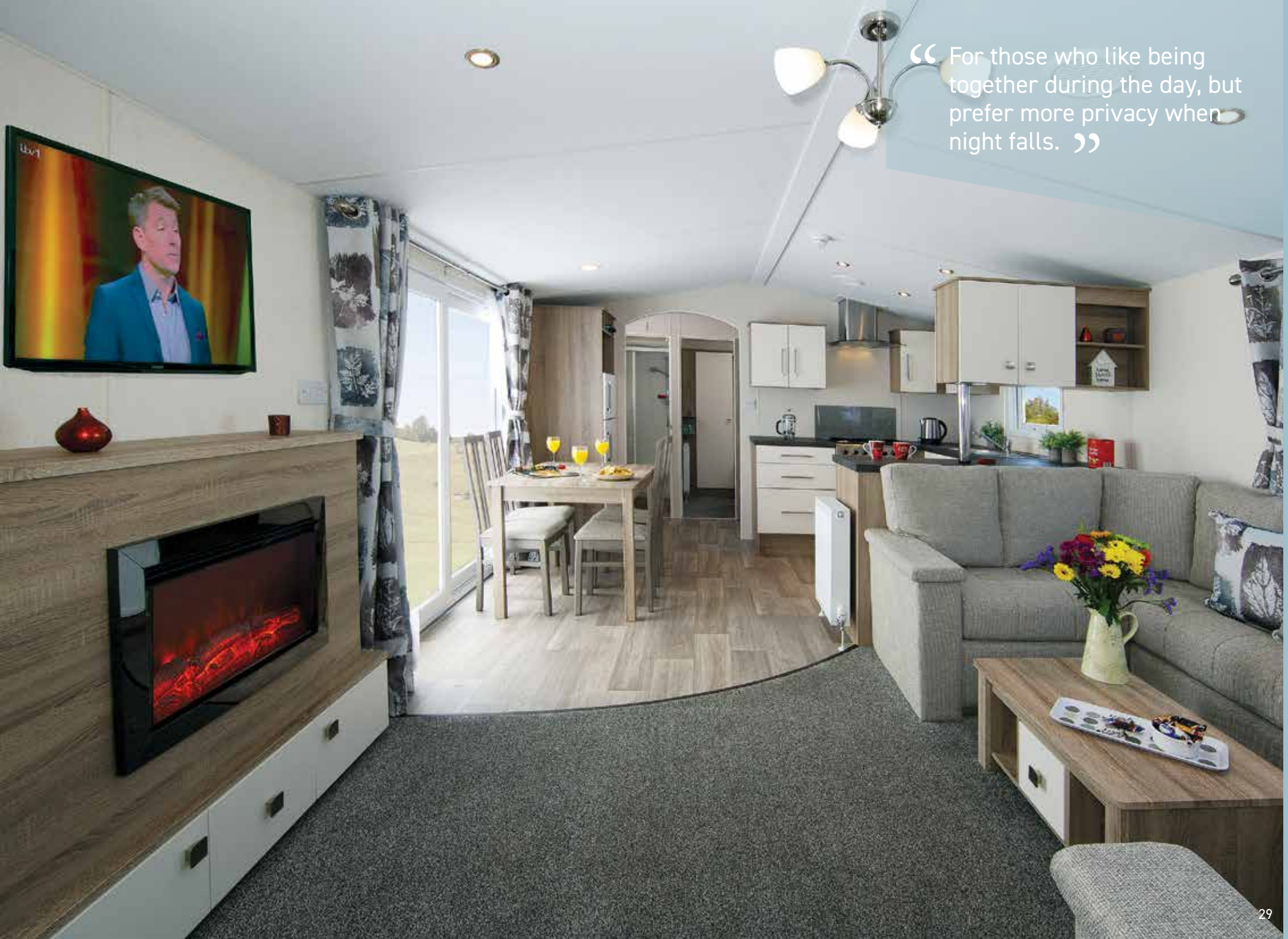



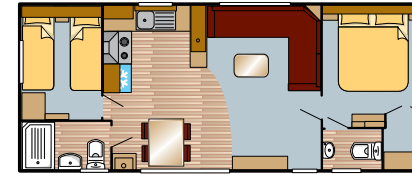

29 x 12 2 Bed

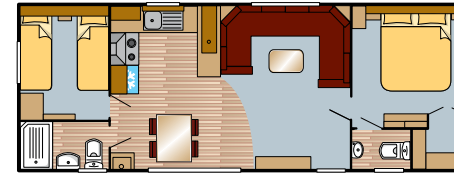

32 x 12 2 Bed



35 x 12 2 Bed

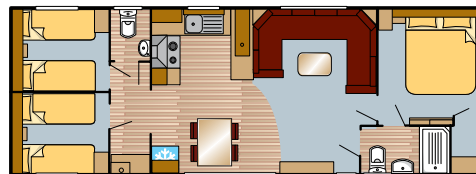

35 x 12 3 Bed



Standard Features

- Painted chassis
- Pan tiled roof
- uPVC cladded exterior
- Domestic style gutters
- Outlook doors
- Exterior light
- White uPVC double glazed
- Central heating
- 50mm fibreglass wall insulation
- 50mm fibreglass roof Insulation
- Electric fire
- Vaulted ceilings throughout
- Net curtains throughout
- Free standing dining table & chairs
- Metal action fold out bed to lounge seating
- Scatter cushions in curtain fabric
- Cooker hood vented to outside
- Integrated fridge freezer (1225mm)
- Integrated cooker
- Shower with thermostatic mixer
- Dual flush WC
- Extractor fan
- Padded headboards
- USB socket in lounge and bedrooms
- Smoke alarm & carbon monoxide detectors

Options

- Pre galvanised chassis
- Chassis fully galvanized 10 year warranty
- Environmental green exterior
- Window colour option (see back of brochure)
- Integrated microwave
- Integrated fridge freezer (full size)
- Integrated cooker with LED clock / minute minder
- Integrated 450mm wide dishwasher
- Deluxe mattress upgrade
- Gazunder bunk beds

Please see our matrix at the back of the brochure for a comprehensive list of options



Standard



Outlook door option

With stunning views through its large panoramic windows and extra all-round insulation, the Maple is the ideal choice to make the most of the extended holiday season. No surprise then that it is so popular with our distributors!

Spacious rooms, contemporary furniture and extensive seating mean you can stretch out in comfort. A stylish and well-equipped domestic-style kitchen includes plenty of cupboards, ample worktop space, a dedicated position for a microwave oven and MDF doors. Well-proportioned bedrooms, a large family shower room and generous storage throughout complete the inventory. In short, this is everything you could want in a holiday home!



“ The Maple is designed to give you an all inclusive spec at an affordable price. ”





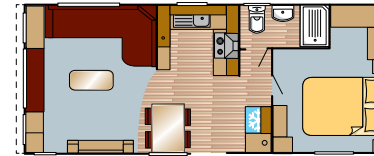

28 x 12 1 Bed

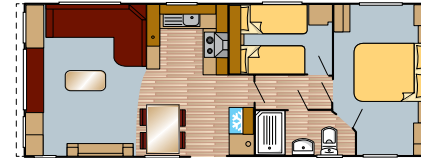

32 x 12 2 Bed

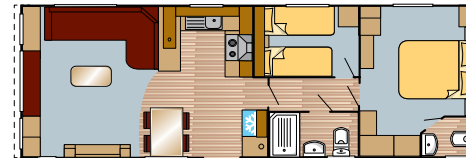

35 x 12 2 Bed

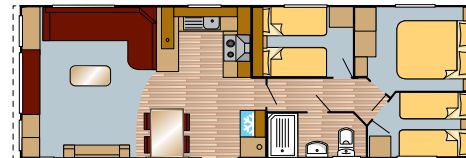

35 x 12 3 Bed

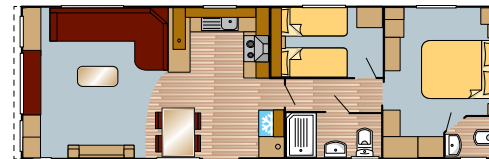

38 x 12 2 Bed

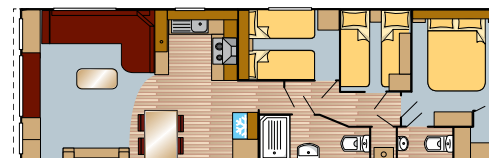

38 x 12 3 Bed

Standard Features

- Painted chassis
- Pan tiled roof
- uPVC cladded exterior
- Domestic style gutters
- Exterior light
- White uPVC double glazed
- Central heating
- 50mm fibreglass wall insulation
- 50mm fibreglass roof Insulation
- Electric fire
- Vaulted ceilings throughout
- Dividing door to hallway (Excluding 28x12 1 bed)
- Net curtains throughout
- Free standing dining table & chairs
- Metal action fold out bed to lounge seating
- Scatter cushions in curtain fabric
- Cooker hood vented to outside
- Integrated fridge freezer (1225mm)
- Integrated cooker
- Shower with thermostatic mixer
- Dual flush WC
- Extractor fan
- Padded headboards
- USB socket in lounge and bedrooms
- Smoke alarm & carbon monoxide detectors

Options

- Pre galvanised chassis
- Chassis fully galvanized 10 year warranty
- Environmental green exterior
- Outlook doors
- Window colour option (see back of brochure)
- Integrated microwave
- Integrated fridge freezer (full size)
- Integrated cooker with LED clock / minute minder
- Integrated 450mm wide dishwasher
- Deluxe mattress upgrade
- Gazunder bunk beds

Please see our matrix at the back of the brochure for a comprehensive list of options

Cypress 12

Scan the QR code to take our online virtual tour



The Cypress 12 offers many of the features you find at home – at a fraction of the price you might expect to pay! With its spacious rooms and contemporary furniture, not surprisingly the Cypress is a popular choice with our distributors.

The comfortable lounge seating and fixed dinette as standard offer ample space for families to get together. A beautiful and well-equipped domestic style kitchen has plenty of storage and worktop space, a position for a microwave oven and the option of a built-in fridge-freezer, all finished with stylish MDF doors.

Spacious bedrooms, a large family shower room and generous storage throughout add the final touches to an impressive specification and make the Cypress a real home from home.



All Cypress 12 photography is of the 35 x 12 2 bed unless otherwise stated. Other models may vary in layout and features. The model shown in this brochure has the following extras: central heating, fridge freezer and exterior light fitted.

“The Cypress range sets the standard with excellent value for money.”





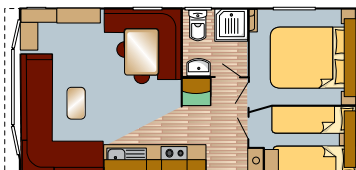

24 x 12 2 Bed

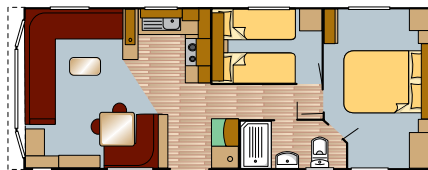

30 x 12 2 Bed

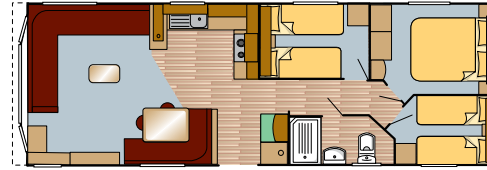

35 x 12 3 Bed

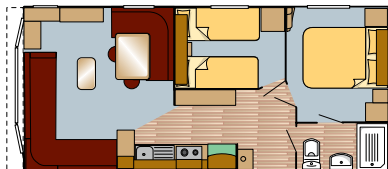

26 x 12 2 Bed

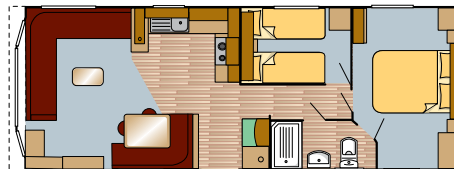

32 x 12 2 Bed

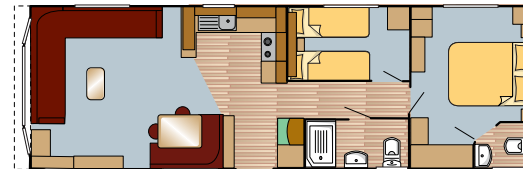

38 x 12 2 Bed

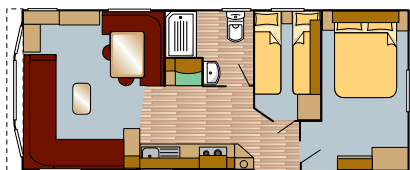

28 x 12 2 Bed



32 x 12 3 Bed

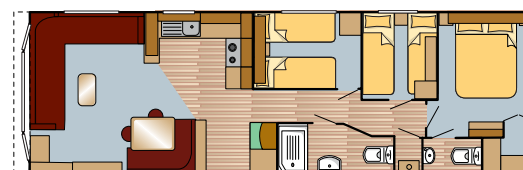

38 x 12 3 Bed

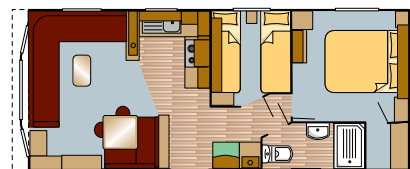

28 x 12 U-shaped 2 Bed

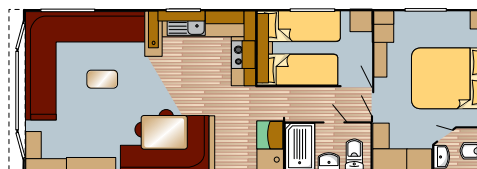

35 x 12 2 Bed



38 x 12 4 Bed

■ Fridge space only



Standard Features

- Painted chassis
- Pan tiled roof
- Wood grain aluminium exterior
- White uPVC double glazed
- Domestic style gutters
- Electric fire
- Vaulted ceilings throughout
- Net curtains throughout
- Metal action fold out bed to lounge seating
- Cooker hood vented to outside
- Integrated cooker
- Shower with thermostatic mixer
- Dual flush WC
- Extractor fan
- USB socket in lounge and bedrooms
- Smoke alarm & carbon monoxide detectors

Options

- Pre galvanised chassis
- Chassis fully galvanized 10 year warranty
- uPVC cladded exterior
- Environmental green exterior
- Window colour option (see back of brochure)
- Exterior light
- Central heating
- Electric plinth Heaters
- 50mm fibreglass wall insulation
- 50mm fibreglass roof Insulation
- Scatter cushions in curtain fabric
- Integrated microwave
- Freestanding fridge with ice box
- Integrated fridge freezer (1225mm)
- Integrated fridge freezer (full size)
- Integrated cooker with LED clock / minute minder
- Integrated 450mm wide dishwasher
- Deluxe mattress upgrade
- Gazunder bunk beds

Please see our matrix at the back of the brochure for a comprehensive list of options

Cypress 10

Scan the QR code to take our online virtual tour



The Cypress range offers many of the comforts of home for considerably less than you might expect! That, and its spacious rooms and modern and stylish furniture, make this model particularly attractive to distributors.

Extensive seating and a fixed dinette provide plenty of room for families to get together and spread out. An attractive and well-equipped domestic style kitchen includes ample storage and worktops, a dedicated position for a microwave and the option of a built-in fridge-freezer, finished off with attractive MDF doors.

The bedrooms are a good size too, and the Cypress has a large family shower room and generous storage throughout. This holiday home has it all!



“ Terrific value for money for such a high specification. ”





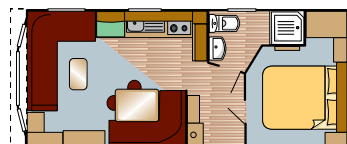

23 x 10 1 Bed

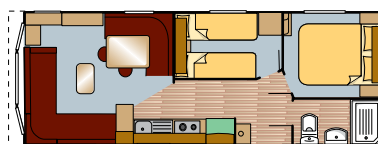

26 x 10 2 Bed



32 x 10 2 Bed



23 x 10 2 Bed



28 x 10 2 Bed



35 x 10 2 Bed

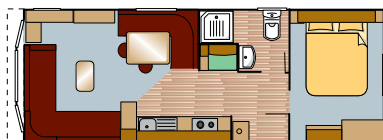

26 x 10 1 Bed



30 x 10 2 Bed



Fridge space only 35 x 10 3 Bed

Standard Features

- Painted chassis
- Pan tiled roof
- Wood grain aluminium exterior
- White uPVC double glazed
- Domestic style gutters
- Electric fire
- Vaulted ceilings throughout
- Net curtains throughout
- Metal action fold out bed to lounge seating
- Cooker hood vented to outside
- Integrated cooker
- Shower with thermostatic mixer
- Dual flush WC
- Extractor fan
- USB socket in lounge and bedrooms
- Smoke alarm & carbon monoxide detectors

Options

- Pre galvanised chassis
- Chassis fully galvanized 10 year warranty
- uPVC cladded exterior
- Environmental green exterior
- Window colour option (see back of brochure)
- Exterior light
- Central heating
- Electric plinth Heaters
- 50mm fibreglass wall insulation
- 50mm fibreglass roof Insulation
- Scatter cushions in curtain fabric
- Integrated microwave
- Freestanding fridge with ice box
- Integrated fridge freezer (1225mm)
- Integrated fridge freezer (full size)
- Integrated cooker with LED clock / minute minder
- Integrated 450mm wide dishwasher
- Deluxe mattress upgrade
- Gazunder bunk beds

Please see our matrix at the back of the brochure for a comprehensive list of options



Standard



Outlook door option

Large front windows or patio doors flood this caravan with light. Contemporary furniture, domestic style doors and vaulted plywood ceilings create a cheerful atmosphere with plenty of space for children to play. After hours, grown-ups can pop a cork here and chill in front of the TV. The fixed dinette can also double as a cards or games table – the perfect way to unwind in the evening. The stylish, two-colour kitchen offers excellent storage and worktops with lots of space for chopping and chatting. Sleep easy in the well-proportioned bedrooms, all of which include plenty of storage for everything from t-shirts and trousers to buckets and spades!



“ Where happy family holidays begin! Ideal for those who like to get away often. ”



Outlook door option





Outlook 35 x12 2 Bed

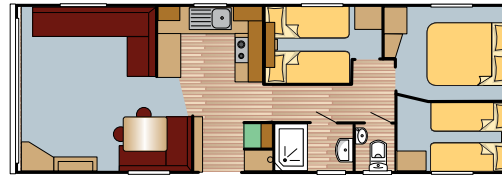

Outlook 35 x12 3 Bed

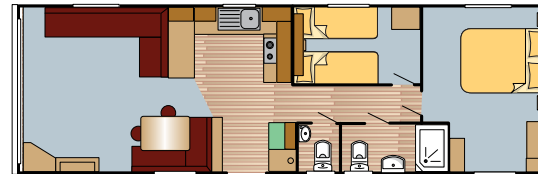

Outlook 38 x12 2 Bed



Outlook 38 x12 3 Bed

Fridge space only



Standard Features

- Painted chassis
- Pan tiled roof
- Plain aluminium exterior
- White uPVC double glazed
- Domestic style gutters
- Electric fire
- Vaulted ceilings throughout
- Integrated cooker
- Shower with thermostatic mixer
- Dual flush WC
- Extractor fan
- USB socket in lounge and bedrooms
- Smoke alarm & carbon monoxide detectors
- Cooker hood vented to outside

Options

- Pre galvanised chassis
- Chassis fully galvanized 10 year warranty
- Environmental green exterior
- Outlook doors
- Window colour option (see back of brochure)
- Exterior light
- Central heating
- Electric plinth Heaters
- 50mm fibreglass wall insulation
- 50mm fibreglass roof Insulation
- Net curtains throughout
- Metal action fold out bed to lounge seating
- Scatter cushions in curtain fabric
- Integrated microwave
- Freestanding fridge with ice box
- Integrated fridge freezer (1225mm)
- Integrated fridge freezer (full size)
- Integrated cooker with LED clock / minute minder
- Integrated 450mm wide dishwasher
- Deluxe mattress upgrade
- Gazunder bunk beds

Please see our matrix at the back of the brochure for a comprehensive list of options



The Rosewood is a comfortable, well-equipped holiday home, with space enough for everyone. Spread out on the extensive lounge seating or open a bottle and unwind as you gaze out through the giant picture window.

Well-designed and practical, the attractive kitchen has ample cupboard space and worktops and the option for integrated appliances. With a fixed dinette with wrap-around seating and stools, mealtimes are a real pleasure. The spacious bedrooms are tastefully designed with plenty of storage. Choose this as your first holiday home and you will not be disappointed!



“Modern and stylish but highly functional, the Rosewood is the perfect entry level holiday home at an affordable price.”





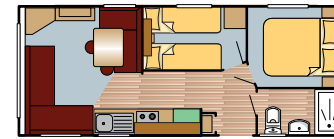

24 x 10 2 Bed

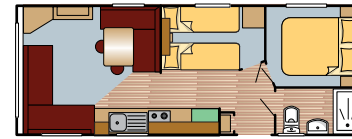

26 x 10 2 Bed



28 x 10 2 Bed

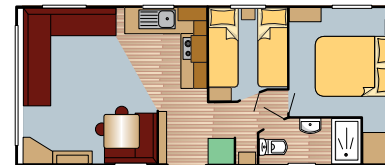

28 x 12 2 Bed

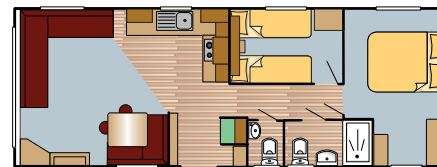

32 x 12 2 Bed

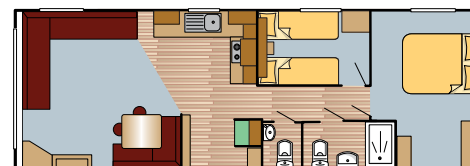

35 x 12 2 Bed

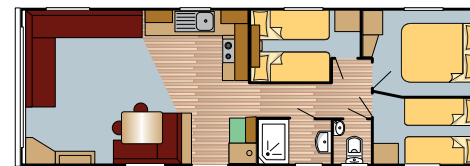

35 x 12 3 Bed

Fridge space only 

Standard Features

- Painted chassis
- Pan tiled roof
- Plain aluminium exterior
- White uPVC double glazed
- Domestic style gutters
- Electric fire
- Vaulted ceilings throughout
- Integrated cooker
- Shower with thermostatic mixer
- Dual flush WC
- Extractor fan
- USB socket in lounge and bedrooms
- Smoke alarm & carbon monoxide detectors
- Cooker hood vented to outside

Options

- Pre galvanised chassis
- Chassis fully galvanized 10 year warranty
- Environmental green exterior
- Window colour option (see back of brochure)
- Exterior light
- Central heating
- Electric plinth Heaters
- 50mm fibreglass wall insulation
- 50mm fibreglass roof Insulation
- Net curtains throughout
- Metal action fold out bed to lounge seating
- Scatter cushions in curtain fabric
- Integrated microwave
- Freestanding fridge with ice box
- Integrated fridge freezer (1225mm)
- Integrated fridge freezer (full size)
- Integrated cooker with LED clock / minute minder
- Integrated 450mm wide dishwasher
- Deluxe mattress upgrade
- Gazunder bunk beds

Please see our matrix at the back of the brochure for a comprehensive list of options

Peace of Mind Warranty

Relax...

All Europa caravans are covered by a minimum parts and labour warranty from the date of purchase by the first owner. This will, however, exclude any damage caused by transport, siting, commissioning, general wear and tear or misuse. The warranty only applies to the original purchaser and is non-transferable.

Below is a list of items covered by extended warranties:



Central Heating Boiler
Fridge/Freezers,
Microwaves,
Cooker Hoods and
Dishwashers



Pan Tiled Roof Sheets,
Walls, Ceilings and Floors
Carpets and Vinyls



Cladding, Gutters and
Downpipes, Electric Sockets
and Switches, Kitchen Sink,
Washbasins, Sanitaryware
and Taps Radiators and
Towel Rails (C/H) Interior Door
Handles



Fully Galvanised Chassis

...we've got you covered!





Features & Options

		Redwood	Sequoia	Mulberry Neo	Mulberry	Willow Classic	Willow	Juniper	Maple	Cypress 12	Cypress 10	Rosewood Outlook	Rosewood
Exterior	Painted chassis	X	X	S	S	S	S	S	S	S	S	S	S
	Pre galvanised chassis	X	X	O	O	O	O	O	O	O	O	O	O
	Chassis fully galvanized 10 year warranty	S	S	O	O	O	O	O	O	O	O	O	O
	Plain aluminium exterior	X	X	X	X	X	X	X	X	O	O	S	S
	Wood grain aluminium exterior	X	X	X	X	X	X	X	X	S	S	X	X
	uPVC cladded exterior	O	S	S	S	S	S	S	S	O	O	X	X
	CanExel cladded exterior	S	X	X	X	X	X	X	X	X	X	X	X
	Exterior door canopy	X	O	X	X	X	X	X	X	X	X	X	X
	Environmental green exterior	O	O	O	O	O	O	O	O	O	O	O	O
	Pan tiled roof	S	S	S	S	S	S	S	S	S	S	S	S
	Domestic style gutters	S	S	S	S	S	S	S	S	S	S	S	S
	Outlook doors	S	O	O	O	O	O	S	O	X	X	O	X
Insulation/ Heating	Exterior light	S	S	S	S	S	S	S	S	O	O	O	O
	Reversible tow-bar facility	S	S	S	S	S	S	S	S	S	S	S	S
	uPVC double glazed	S	S	S	S	S	S	S	S	S	S	S	S
	Central heating	S	S	S	S	S	S	S	S	O	O	O	O
	Electric plinth heaters	O	O	O	O	O	O	O	O	O	O	O	O
	External pipe lagging	S	S	S	S	S	S	S	S	S	S	S	S
	25mm fibreglass floor Insulation	S	S	S	S	S	S	S	S	S	S	S	S
	25mm fibreglass wall insulation	X	X	X	X	X	X	X	X	S	S	S	S
	50mm fibreglass wall insulation	S	S	S	S	S	S	S	S	O	O	O	O
	25mm fibreglass roof Insulation	X	X	X	X	X	X	X	X	S	S	S	S
	50mm fibreglass roof insulation	S	S	S	S	S	S	S	S	O	O	O	O
Lounge/ Dining	Roof insulation'Drantherm' bubble foil	S	S	S	S	S	S	S	S	S	S	S	S
	Electric fire	S	S	S	S	S	S	S	S	S	S	S	S
	Vaulted ceilings throughout	S	S	S	S	S	S	S	S	S	S	S	S
	Dividing door to hallway	S	S	S	S	*S	*S	X	***S	X	X	O	O
	Net curtains throughout	X	X	O	O	S	S	S	S	S	S	O	O
	Free standing dining table & chairs	S	S	S	S	S	S	S	S	O	X	O	O
Kitchen	Metal action fold out bed to lounge seating	S	S	S	S	S	S	S	S	S	S	O	O
	Cooker hood vented to outside	S	S	S	S	S	S	S	S	S	S	S	S
	Integrated microwave	S	S	S	S	S	S	O	O	O	O	O	O
	Freestanding fridge with ice box	X	X	X	X	X	X	X	X	O	O	O	O
	Integrated fridge freezer (1225mm)	X	X	X	X	X	X	S	S	O	O	O	O
	Integrated fridge freezer (full size)	S	S	S	S	**S	**S	O	O	O	O	O	O
	Integrated cooker	X	X	X	X	X	X	S	S	S	S	S	S
	Integrated oven & grill with separate hob	S	S	X	X	X	X	X	X	X	X	X	X
	Integrated cooker with LED clock / minute minder	X	X	S	S	S	S	O	O	O	O	O	O
Bathroom	Integrated 450mm wide dishwasher	S	S	O	O	O	O	O	O	O	O	O	O
	Shower with thermostatic mixer	S	S	S	S	S	S	S	S	S	S	S	S
	Dual flush WC	S	S	S	S	S	S	S	S	S	S	S	S
	Bath with thermostatic mixer shower over	S	O	X	X	X	X	X	X	X	X	X	X
Bedroom	Extractor fan	S	S	S	S	S	S	S	S	S	S	S	S
	Lift up storage bed to main bedroom	X	S	S	S	S	S	O	O	O	O	O	O
	Divan bed with storage	S	X	X	X	X	X	X	X	X	X	X	X
	Gazunder bunk beds	O	O	O	O	O	O	O	O	O	O	O	O
	Deluxe mattress upgrade	S	S	O	O	O	O	O	O	O	O	O	O
	Tuftained mattresses	O	O	O	O	O	O	O	O	O	O	O	O
	Padded headboards	S	S	S	S	S	S	S	S	O	O	X	X
Safety	Smoke alarm (10 year battery)	S	S	S	S	S	S	S	S	S	S	S	S
	Carbon monoxide detectors (7 year battery)	S	S	S	S	S	S	S	S	S	S	S	S
	Fire extinguisher	O	O	O	O	O	O	O	O	O	O	O	O
	Fire blanket	O	O	O	O	O	O	O	O	O	O	O	O

S Standard O Optional X Not Available * 32x12 2 bed Willow - dividing door not available ** 32x12 2 bed Willow - Integrated fridge freezer (1225mm) with microwave above *** 28X12 1 Bed Maple - dividing door not available

Dimensions

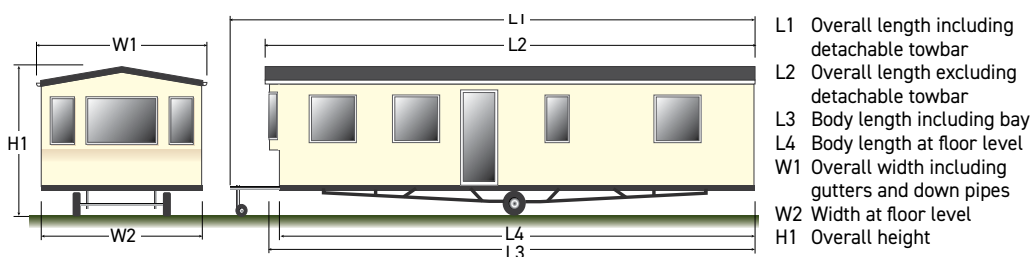

Redwood	L1	L2	L3	L4	W1	W2	H1
36'x13' 2 Bed	11.92m (39'1")	11.27m (37'0")	11.02m (36'2")	11.02m (36'2")	4.25m (13'11")	4m (13'1")	3.50m (11'6")
38'x13' 2 Bed	12.53m (41'1")	11.88m (39'0")	11.63m (38'2")	11.63m (38'2")	4.25m (13'11")	4m (13'1")	3.50m (11'6")
40'x13' 2 Bed	13.14m (43'1")	12.49m (41'0")	12.24m (40'2")	12.24m (40'2")	4.25m (13'11")	4m (13'1")	3.50m (11'6")
43 x 13 2 Bed	14.05m (46'1")	13.40m (43'11")	13.15m (43'1")	13.15m (43'1")	4.25m (13'11")	4m (13'1")	3.50m (11'6")
43'x14' 2 Bed	14.05m (46'1")	13.40m (43'11")	13.15m (43'1")	13.15m (43'1")	4.60m (14'11")	4.35m (14'1")	3.90m (12'9")

Sequoia	L1	L2	L3	L4	W1	W2	H1
40 x 13 2 Bed	13.14m (43'1")	12.49m (40'11")	12.24m (40'1")	12.24m (40'1")	4.27m (14'0")	4m (13'1")	3.50m (11'6")
41 x 13 3 Bed	13.44m (44'1")	12.79m (41'11")	12.54m (41'1")	12.54m (41'1")	4.27m (14'0")	4m (13'1")	3.50m (11'6")
42 x 13 2 Bed	13.75m (45'1")	13.10m (42'11")	12.85m (42'1")	12.85m (42'1")	4.27m (14'0")	4m (13'1")	3.50m (11'6")
43 x 13 3 Bed	14.05m (46'1")	13.40m (43'11")	13.15m (43'1")	13.15m (43'1")	4.27m (14'0")	4m (13'1")	3.50m (11'6")

Mulberry Neo	L1	L2	L3	L4	W1	W2	H1
32 x 12 2 Bed	10.97m (35'11")	10.21m (33'5")	10.07m (33'0")	10.07m (33'0")	3.99m (13'1")	3.73m (12'2")	3.50m (11'6")
36 X 12 2 Bed	11.91m (39'0")	11.15m (36'6")	11.01m (36'1")	11.01m (36'1")	3.99m (13'1")	3.73m (12'2")	3.50m (11'6")
36 x 12 3 Bed	11.91m (39'0")	11.15m (36'6")	11.01m (36'1")	11.01m (36'1")	3.99m (13'1")	3.73m (12'2")	3.50m (11'6")
38 X 12 2 Bed	12.52m (41'0")	11.76m (38'6")	11.62m (38'1")	11.62m (38'1")	3.99m (13'1")	3.73m (12'2")	3.50m (11'6")
38 X 12 3 Bed	12.52m (41'0")	11.76m (38'6")	11.62m (38'1")	11.62m (38'1")	3.99m (13'1")	3.73m (12'2")	3.50m (11'6")
40 X 12 3 Bed	13.14m (43'1")	12.38m (40'7")	12.24m (40'1")	12.24m (40'1")	3.99m (13'1")	3.73m (12'2")	3.50m (11'6")

Mulberry	L1	L2	L3	L4	W1	W2	H1
32 x 12 2 Bed	10.97m (35'11")	10.21m (33'5")	10.07m (33'0")	10.07m (33'0")	3.99m (13'1")	3.73m (12'2")	3.50m (11'6")
36 X 12 2 Bed	11.91m (39'0")	11.15m (36'6")	11.01m (36'1")	11.01m (36'1")	3.99m (13'1")	3.73m (12'2")	3.50m (11'6")
36 x 12 3 Bed	11.91m (39'0")	11.15m (36'6")	11.01m (36'1")	11.01m (36'1")	3.99m (13'1")	3.73m (12'2")	3.50m (11'6")
38 X 12 2 Bed	12.52m (41'0")	11.76m (38'6")	11.62m (38'1")	11.62m (38'1")	3.99m (13'1")	3.73m (12'2")	3.50m (11'6")
38 X 12 3 Bed	12.52m (41'0")	11.76m (38'6")	11.62m (38'1")	11.62m (38'1")	3.99m (13'1")	3.73m (12'2")	3.50m (11'6")
40 X 12 3 Bed	13.14m (43'1")	12.38m (40'7")	12.24m (40'1")	12.24m (40'1")	3.99m (13'1")	3.73m (12'2")	3.50m (11'6")

Willow Classic (2S)* = 2x Shower	L1	L2	L3	L4	W1	W2	H1
32 x 12 2 Bed	10.82m (35'5")	10.07m (33'0")	10.02m (32'10")	10.02m (32'10")	3.99m (13'1")	3.73m (12'2")	3.50m (11'6")
36 x 12 2 Bed	11.82m (38'9")	11.07m (36'3")	11.02m (36'1")	11.02m (36'1")	3.99m (13'1")	3.73m (12'2")	3.50m (11'6")
36 X 12 3 Bed	11.82m (38'9")	11.07m (36'3")	11.02m (36'1")	11.02m (36'1")	3.99m (13'1")	3.73m (12'2")	3.50m (11'6")
38x 12 2 Bed	12.43m (40'9")	11.68m (38'3")	11.63m (38'1")	11.63m (38'1")	3.99m (13'1")	3.73m (12'2")	3.50m (11'6")
38x 12 2 Bed (2S)*	12.43m (40'9")	11.68m (38'3")	11.63m (38'1")	11.63m (38'1")	3.99m (13'1")	3.73m (12'2")	3.50m (11'6")
38x 12 3 Bed	12.43m (40'9")	11.68m (38'3")	11.63m (38'1")	11.63m (38'1")	3.99m (13'1")	3.73m (12'2")	3.50m (11'6")

Willow (2S)* = 2x Shower	L1	L2	L3	L4	W1	W2	H1
32 x 12 2 Bed	10.82m (35'5")	10.07m (33'0")	10.02m (32'10")	10.02m (32'10")	3.99m (13'1")	3.73m (12'2")	3.50m (11'6")
36 x 12 2 Bed	11.82m (38'9")	11.07m (36'3")	11.02m (36'1")	11.02m (36'1")	3.99m (13'1")	3.73m (12'2")	3.50m (11'6")
36 X 12 3 Bed	11.82m (38'9")	11.07m (36'3")	11.02m (36'1")	11.02m (36'1")	3.99m (13'1")	3.73m (12'2")	3.50m (11'6")
38x 12 2 Bed	12.43m (40'9")	11.68m (38'3")	11.63m (38'1")	11.63m (38'1")	3.99m (13'1")	3.73m (12'2")	3.50m (11'6")
38x 12 2 Bed (2S)*	12.43m (40'9")	11.68m (38'3")	11.63m (38'1")	11.63m (38'1")	3.99m (13'1")	3.73m (12'2")	3.50m (11'6")
38x 12 3 Bed	12.43m (40'9")	11.68m (38'3")	11.63m (38'1")	11.63m (38'1")	3.99m (13'1")	3.73m (12'2")	3.50m (11'6")

Juniper	L1	L2	L3	L4	W1	W2	H1
29 x 12 2 Bed CL	9.75m (31'11")	8.85m (29'0")	8.85m (29'0")	8.85m (29'0")	3.99m (13'1")	3.73m (12'2")	3.40m (11'1")
32x 12 2 Bed CL	10.73m (35'2")	9.83m (32'3")	9.83m (32'3")	9.83m (32'3")	3.99m (13'1")	3.73m (12'2")	3.40m (11'1")
35x 12 2 Bed CL	11.64m (38'2")	10.74m (35'2")	10.74m (35'2")	10.74m (35'2")	3.99m (13'1")	3.73m (12'2")	3.40m (11'1")
35x 12 3 Bed CL	11.64m (38'2")	10.74m (35'2")	10.74m (35'2")	10.74m (35'2")	3.99m (13'1")	3.73m (12'2")	3.40m (11'1")

Maple	L1	L2	L3	L4	W1	W2	H1
28 x 12 1 Bed	9.70m (31'9")	9.00m (29'6")	8.80m (28'10")	8.80m (28'10")	3.99m (13'1")	3.73m (12'2")	3.40m (11'1")
32 x 12 2 Bed	10.80m (35'5")	10.10m (33'1")	9.90m (32'5")	9.90m (32'5")	3.99m (13'1")	3.73m (12'2")	3.40m (11'1")
35 x 12 2 Bed	11.90m (39'0")	11.20m (36'8")	11m (36'1")	11m (36'1")	3.99m (13'1")	3.73m (12'2")	3.40m (11'1")
35 x 12 3 Bed	11.90m (39'0")	11.20m (36'8")	11m (36'1")	11m (36'1")	3.99m (13'1")	3.73m (12'2")	3.40m (11'1")
38 x 12 2 Bed	12.53m (41'1")	11.83m (38'9")	11.63m (38'1")	11.63m (38'1")	3.99m (13'1")	3.73m (12'2")	3.40m (11'1")
38 x 12 3 Bed	12.53m (41'1")	11.83m (38'9")	11.63m (38'1")	11.63m (38'1")	3.99m (13'1")	3.73m (12'2")	3.40m (11'1")

Cypress 12							
24 x 12.2 Bed	8.34m (27'4")	7.74m (25'4")	7.62m (25'0")	7.44m (24'4")	3.93m (12'10")	3.66m (12'0")	3.40m (11'1")
26 x 12.2 Bed	8.98m (29'5")	8.38m (27'5")	8.27m (27'1")	8.08m (26'6")	3.93m (12'10")	3.66m (12'0")	3.40m (11'1")
28 x 12.2 Bed	9.66m (31'8")	9.06m (29'8")	8.94m (29'3")	8.76m (28'8")	3.93m (12'10")	3.66m (12'0")	3.40m (11'1")
30 x 12.2 Bed	10.05m (32'11")	9.45m (31'0")	9.33m (30'7")	9.15m (30'0")	3.93m (12'10")	3.66m (12'0")	3.40m (11'1")
32 x 12.2 Bed	10.73m (35'2")	10.13m (33'2")	10.01m (32'10")	9.83m (32'3")	3.93m (12'10")	3.66m (12'0")	3.40m (11'1")
32 x 12.3 Bed	10.73m (35'2")	10.13m (33'2")	10.01m (32'10")	9.83m (32'3")	3.93m (12'10")	3.66m (12'0")	3.40m (11'1")
35 x 12.2 Bed	11.64m (38'2")	11.04m (36'2")	10.93m (35'10")	10.74m (35'2")	3.93m (12'10")	3.66m (12'0")	3.40m (11'1")
35 x 12.3 Bed	11.64m (38'2")	11.04m (36'2")	10.93m (35'10")	10.74m (35'2")	3.93m (12'10")	3.66m (12'0")	3.40m (11'1")
38 x 12.2 Bed	12.47m (40'10")	11.87m (38'11")	11.76m (38'7")	11.57m (37'11")	3.93m (12'10")	3.66m (12'0")	3.40m (11'1")
38 x 12.3 Bed	12.47m (40'10")	11.87m (38'11")	11.76m (38'7")	11.57m (37'11")	3.93m (12'10")	3.66m (12'0")	3.40m (11'1")
38 x 12.4 Bed	12.49m (40'11")	11.89m (39'0")	11.77m (38'7")	11.59m (38'0")	3.93m (12'10")	3.66m (12'0")	3.40m (11'1")

Cypress 10							
23 x 10.1 Bed	8.12m (26'7")	7.52m (24'8")	7.41m (24'3")	7.22m (23'8")	3.32m (10'10")	3.05m (10'0")	3.24m (10'7")
23 x 10.2 Bed	8.12m (26'7")	7.52m (24'8")	7.41m (24'3")	7.22m (23'8")	3.32m (10'10")	3.05m (10'0")	3.24m (10'7")
26 x 10.1 Bed	8.98m (29'5")	8.38m (27'5")	8.26m (27'1")	8.08m (26'6")	3.32m (10'10")	3.05m (10'0")	3.24m (10'7")
26 x 10.2 Bed	8.98m (29'5")	8.38m (27'5")	8.26m (27'1")	8.08m (26'6")	3.32m (10'10")	3.05m (10'0")	3.24m (10'7")
28 x 10.2 Bed	9.66m (31'8")	9.06m (29'8")	8.94m (29'3")	8.76m (28'8")	3.32m (10'10")	3.05m (10'0")	3.24m (10'7")
30 x 10.2 Bed	10.05m (32'11")	9.45m (31'0")	9.33m (30'7")	9.15m (30'0")	3.32m (10'10")	3.05m (10'0")	3.24m (10'7")
32 x 10.2 Bed	10.73m (35'2")	10.13m (33'2")	10.01m (32'10")	9.83m (32'3")	3.32m (10'10")	3.05m (10'0")	3.24m (10'7")
35 x 10.2 Bed	11.58m (37'11")	10.97m (35'11")	10.86m (35'7")	10.68m (35'0")	3.32m (10'10")	3.05m (10'0")	3.24m (10'7")
35 x 10.3 Bed	11.85m (38'10")	11.25m (36'10")	11.13m (36'6")	10.95m (35'11")	3.32m (10'10")	3.05m (10'0")	3.24m (10'7")

Rosewood Outlook							
35 x 12.2 Bed	11.63m (38'1")	10.86m (35'7")	10.74m (35'2")	10.74m (35'2")	3.93m (12'10")	3.66m (12'0")	3.40m (11'1")
35 x 12.3 Bed	11.63m (38'1")	10.86m (35'7")	10.74m (35'2")	10.74m (35'2")	3.93m (12'10")	3.66m (12'0")	3.40m (11'1")
38 x 12.2 Bed	12.46m (40'10")	11.69m (38'4")	11.57m (37'11")	11.57m (37'11")	3.93m (12'10")	3.66m (12'0")	3.40m (11'1")
38 x 12.3 Bed	12.46m (40'10")	11.69m (38'4")	11.57m (37'11")	11.57m (37'11")	3.93m (12'10")	3.66m (12'0")	3.40m (11'1")

Rosewood							
24 x 10.2 Bed	8.45m (27'8")	7.69m (25'2")	7.57m (24'10")	7.57m (24'10")	3.32m (10'10")	3.05m (10'0")	3.24m (10'7")
26 x 10.2 Bed	8.99m (29'5")	8.22m (26'11")	8.10m (26'6")	8.10m (26'6")	3.32m (10'10")	3.05m (10'0")	3.24m (10'7")
28 x 10.2 Bed	9.64m (31'7")	8.87m (29'1")	8.76m (28'8")	8.76m (28'8")	3.32m (10'10")	3.05m (10'0")	3.24m (10'7")
28 x 12.2 Bed	9.64m (31'7")	8.87m (29'1")	8.76m (28'8")	8.76m (28'8")	3.93m (12'10")	3.66m (12'0")	3.40m (11'1")
32 x 12.2 Bed	10.80m (35'5")	10.03m (32'10")	9.92m (32'6")	9.92m (32'6")	3.93m (12'10")	3.66m (12'0")	3.40m (11'1")
35 x 12.2 Bed	11.62m (38'1")	10.85m (35'7")	10.74m (35'2")	10.74m (35'2")	3.93m (12'10")	3.66m (12'0")	3.40m (11'1")
35 x 12.3 Bed	11.62m (38'1")	10.85m (35'7")	10.74m (35'2")	10.74m (35'2")	3.93m (12'10")	3.66m (12'0")	3.40m (11'1")

PROLOCKED Security Windows

The last word in window security – ProLocked Window System utilises its unique and cutting-edge internal beading system to make it impossible to remove the glass from the outside.

Features & Benefits

- Internally glazed as standard. More secure than most other systems
- Thermally efficient window design meets BS EN1647:2012 and BS 3632:2015
- Concealed multi-point locking system. Our single handle also allows easier opening and closing
- Latest metal technology – espagnolettes use nano-particles for extreme scratch resistance and corrosion protection
- Fixing system from 38mm up to large wall. Increased depth of coverage on cladding
- Includes a plasterboard adapter
- Bay solution also available
- Choice of 4 foils.



Golden Oak

Anthracite Grey

Dark Green

Antique Teak



Europa Caravans UK, Unit 3, Wyke Works, Hedon Road, Hull, East Yorkshire, HU9 5NL
Telephone: 01482 226682,
Email: info@europacaravans.com
www.europacaravans.com



Dealer